

SWING CHECK-VALVE



TECHNICAL SPECIFICATIONS

Nomina Diameter	DN50 – DN300
Nomina Pressure	PN10 – 16
Design Standard	EN 16767
Flange Standard	EN 1092-2
Marking	EN 19
Dimensions	EN 558-S48 (3202 F6)
Test Standard	EN 12266-1
Operating Pressure	-10 °C ... +50 °C
Coating	Thermoplastic / Epoxy



APPLICATION AREAS

1

Drinking Water

2

Industrial

3

Irrigation Systems

Check Valves are used widely in pipelines conveying liquids, gases and steam. They prevent the fluid from back flow in a very simple manner. The only moving part in the check-valve is the disc with seal, hinged on the body to rotate freely, closing at an angle of 5°. This design detail ensures the drip tight closing of the disc by gravity even at very low or no-pressure applications. The disc opens in the direction of flow by the inertial effect of the moving fluid automatically. Only at no-flow condition the disc returns to its seat, preventing back flow drip tight. This offers a one-way flow through the valve. The use of swing type check-valves are very important mostly at the outlet of pumps. It is very important that the disc closes rapidly in pump applications with turn-off or electricity cut-off, before reversing flow slams the disc back to its seat, inducing waterhammer other than induced by the rapid velocity change in the pipeline. Counterweight is added to the check-valve disc stem for that purpose as an optional feature.

MATERIAL FEATURES

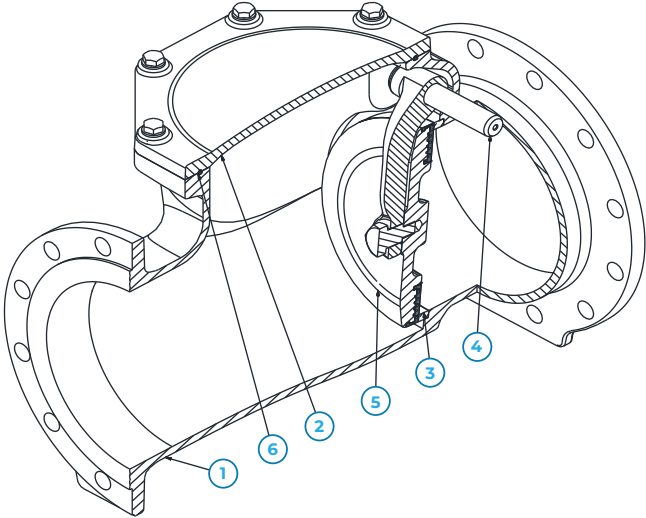

NO	PART NAME	MATERIAL	OPTION
1	BODY	EN GJS 400-15	EN GJS 500-7
2	COVER	EN GJS 400-15	EN GJS 500-7
3	SEALING BUSH	AISI304	BRONZE
4	STEM	AISI420	DUPLEX
5	DISC	EN GJS 400-15 + EPDM	-
6	O-RINGS	EPDM	NBR
	FIXING	A2	A4

ACTUATION TYPES

STANDARD

LEVER AND COUNTERWEIGHT

COUNTERWEIGHT AND LIMIT SWITCH

Our company reserves the right to make changes to the dimensions. For product dimensions and pressure classes not listed in the catalog, please contact our sales team.

DIMENSIONS

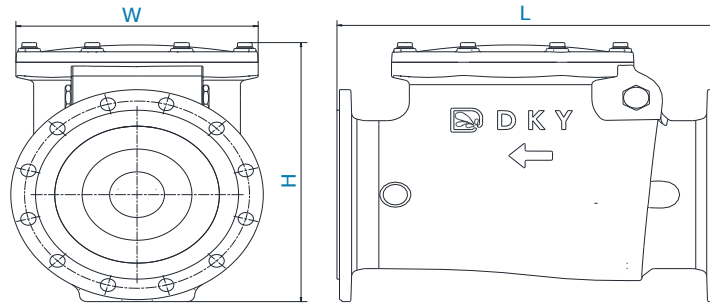

SWING CHECK-VALVE

Anma Çapı	PN	L	W	H	kg
DN 50	10 - 16	200	165	180	10
DN 65	10 - 16	240	185	200	12
DN 80	10 - 16	260	200	220	16
DN 100	10 - 16	300	220	240	20
DN 125	10 - 16	350	250	280	30
DN 150	10 - 16	400	285	320	45
DN 200	10	500	340	400	70
	16	500	340	400	73
DN 250	10	600	395	485	110
	16	600	405	485	110
DN 300	10	700	460	570	175
	16	700	460	570	180

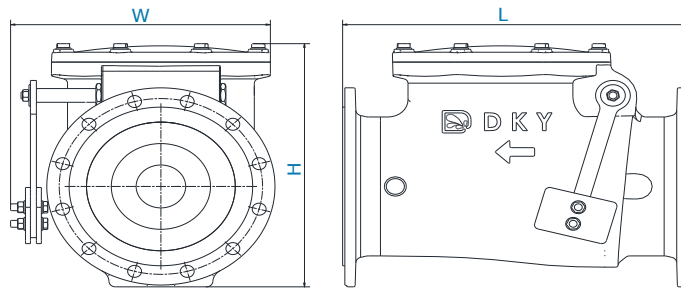

SWING CHECK-VALVE with LEVER and COUNTERWEIGHT

Anma Çapı	PN	L	W	H	kg
DN 50	10 - 16	200	205	180	13
DN 65	10 - 16	240	220	200	15
DN 80	10 - 16	260	235	220	20
DN 100	10 - 16	300	260	240	25
DN 125	10 - 16	350	287	280	34
DN 150	10 - 16	400	330	320	50
DN 200	10	500	385	400	75
	16	500	385	400	80
DN 250	10	600	455	485	120
	16	600	485	485	125
DN 300	10	700	528	570	185
	16	700	533	570	195